

GDT Product Specification

BM***M SMD Gas Discharge Tube (8.3×8.3×6mm)



1、FEATURES

- Surface Mounting Design UL Certified E232249
- Size Design EIA 3225 8.3×8.3×6mm
- High Current Handling Capability 20,000A @ 8/20μs
- Low Capacitance and Insertion Loss
- Fast Response and Long Service Life
- Reliable to Protect Electrostatic Surge



2、AVAILABLE PART NUMBER AND ELECTRICAL PARAMETER @ T=25°C RH = 45%-75%

Part Number	DC Breakdown Voltage①	Tolerance of Vs	Impulse Spark-over Voltage	Impulse Discharge Current②	Insulation Resistance		C③ (1MHz)
	100V/s④		1kV/μs④	8/20μs	GΩ	DC	0.3V _{DC}
BM071M	70V	±20%	≤ 600V	20,000A	≥1	25V	≤1.5pF
BM091M	90V	±20%	≤ 600V	20,000A	≥1	50V	≤1.5pF
BM151M	150V	±20%	≤ 500V	20,000A	≥1	50V	≤1.5pF
BM201M	200V	±20%	≤ 550V	20,000A	≥1	100V	≤1.5pF
BM231M	230V	±20%	≤ 600V	20,000A	≥1	100V	≤1.5pF
BM301M	300V	±20%	≤ 650V	20,000A	≥1	100V	≤1.5pF
BM351M	350V	±20%	≤ 700V	20,000A	≥1	100V	≤1.5pF
BM421M	400V	±20%	≤ 800V	20,000A	≥1	100V	≤1.5pF
BM471M	470V	±20%	≤ 850V	20,000A	≥1	250V	≤1.5pF
BM601M	600V	±20%	≤ 950V	20,000A	≥1	250V	≤1.5pF
BM801M	800V	±20%	≤ 1200V	20,000A	≥1	500V	≤1.5pF
BM102M	1000V	±20%	≤ 1500V	20,000A	≥1	500V	≤1.5pF
BM152M	1500V	±20%	≤ 2500V	10,000A	≥1	250V	≤1.5pF
BM202M	2000V	±20%	≤ 3000V	10,000A	≥1	250V	≤1.5pF
BM252M	2500V	±20%	≤ 3500V	10,000A	≥1	250V	≤1.5pF
BM302M	3000V	±20%	≤ 4000V	10,000A	≥1	250V	≤1.5pF
BM362M	3600V	±20%	≤ 5000V	10,000A	≥1	250V	≤1.5pF
BM402M	4000V	±20%	≤ 5500V	10,000A	≥1	250V	≤1.5pF
BM452M	4500V	±20%	≤ 6500V	10,000A	≥1	250V	≤1.5pF
BM552M	5000V	±20%	≤ 7500V	10,000A	≥1	250V	≤1.5pF

- ①、The parameters of all are tested by ITU-T K12
- ②、Total Impulse Discharge Current 20,000A @ 8/20μs by IEC 61000-4-5, 10 shots
- ③、The capacitance are tested by 1MHzHz @ DC= 0.3V
- ④、The V-T waveform of DCBV and IPBV mus lie between the shades.

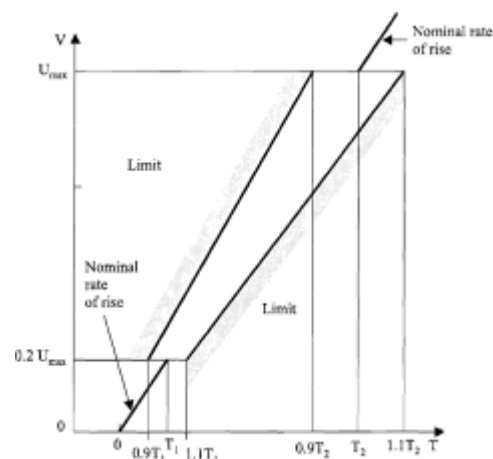

GDT Product Specification

BM***M SMD Gas Discharge Tube (8.3×8.3×6mm)



3、PART NUMBERING SYSTEM

BM **XXX** **M**
 (1) (2) (3)

- (1) Bencent SMD Gas Discharge Tube in 8.3×8.3×6 (L×W×H) (mm),
 Total Impulse Discharge Current 20,000A @8/20μs
- (2) DC Breakdown Voltage, e.g., 151=15×10¹=150V
- (3) Tolerance is DC Breakdown Voltage, M=+-20%, N=+-30%

4、DIMENSIONS

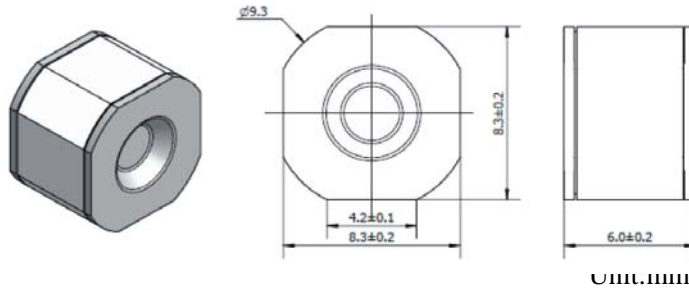

5、RECOMMENDED SOLDERING PAD AND REFLOW PROFILE

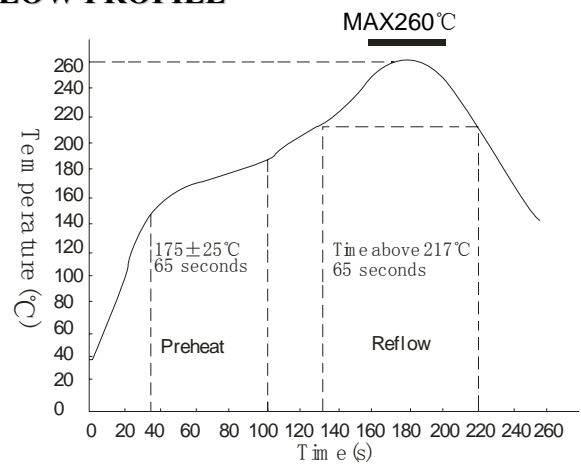
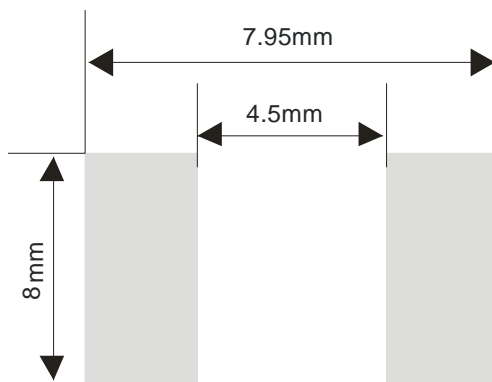

6、PACKAGE REEL INFORMATION

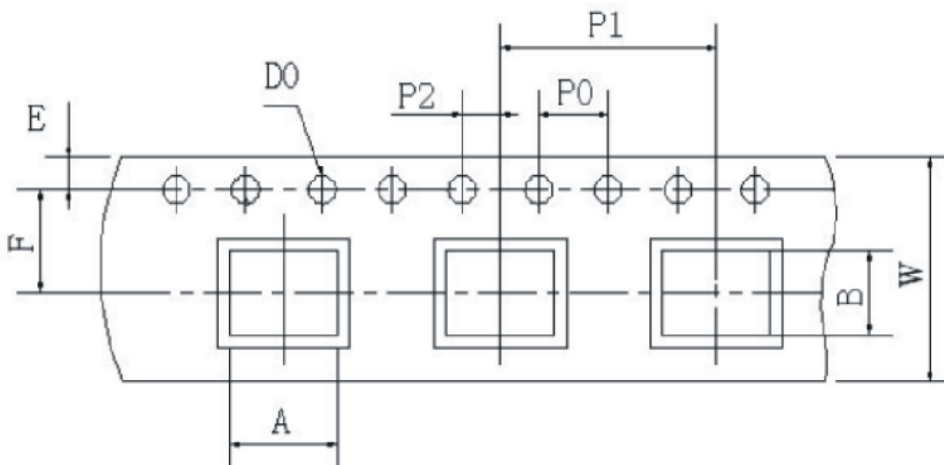

ITEM	DIM (mm)
A	6.5 ± 0.1
B	8.4 ± 0.1
D0	φ1.50 ± 0.10
E	1.75 ± 0.10
F	7.5 ± 0.1
P0	4.0 ± 0.1
P1	12 ± 0.1
P2	2.0 ± 0.1
W	16.5 ± 0.4

GDT Product Specification

BM***M SMD Gas Discharge Tube (8.3×8.3×6mm)



OUTLINE	REEL (PCS)	PER CARTON (PCS)	REEL DIAMETERS (mm)	CARTON SIZE(mm)		
				L	W	H
TAPING	400	3,200	330	360	360	360

Remark:

Special Notes

- 1、 Bencent Electronics Limited (BENCENT) reserves the right to make changes without further notice to its products herein.
- 2、 BENCENT does not assumes any liability arising out of the application or usage of any product or circuit, and specifically disclaims any and all liability, including without limitation special, consequential or incidental damages.
- 3、 Any special usage must be authorized by BENCENT in advance; otherwise BENCENT does not take any liability of it.

Date Issued:2010/03